

**This electronic collection of documents is provided  
for the convenience of the user  
and is Not a Certified Document –**

**The documents contained herein were originally issued  
and sealed by the individuals whose names and license  
numbers appear on each page, on the dates appearing  
with their signature on that page.**

**This file or an individual page  
shall not be considered a certified document.**

STATE OF NORTH CAROLINA  
 DIVISION OF HIGHWAYS

PROJ. REFERENCE NO.	SHEET NO.
17BP.14.R.79	X-1A

NOTE: EMBANKMENT COLUMN DOES NOT INCLUDE BACKFILL FOR UNDERCUT

**CROSS-SECTION SUMMARY**

STATION	-L-	UNCL. EXC. (CY)	EMBT. (CY)																							
<b>10+25.00</b>		-	-																							
<b>10+50.00</b>		1	1																							
<b>11+00.00</b>		3	7																							
<b>11+50.00</b>		26	25																							
<b>12+00.00</b>		9	30																							
<b>12+50.00</b>		2	12																							
<b>13+00.00</b>		3	6																							
<b>-DET- BASED OFF -L-</b>																										
<b>10+50.00</b>		-	-																							
<b>11+00.00</b>		12	0																							
<b>11+25.00</b>		8	0																							

Note:  
 Approximate quantities only. Unclassified excavation, borrow  
 excavation, fine grading, clearing and grubbing, and removal of existing  
 pavement will be paid for at the lump sum price for "Grading".

8/23/99

0 2.5 5	PROJ. REFERENCE NO.	SHEET NO.
	17BP.14.R.79	X-1

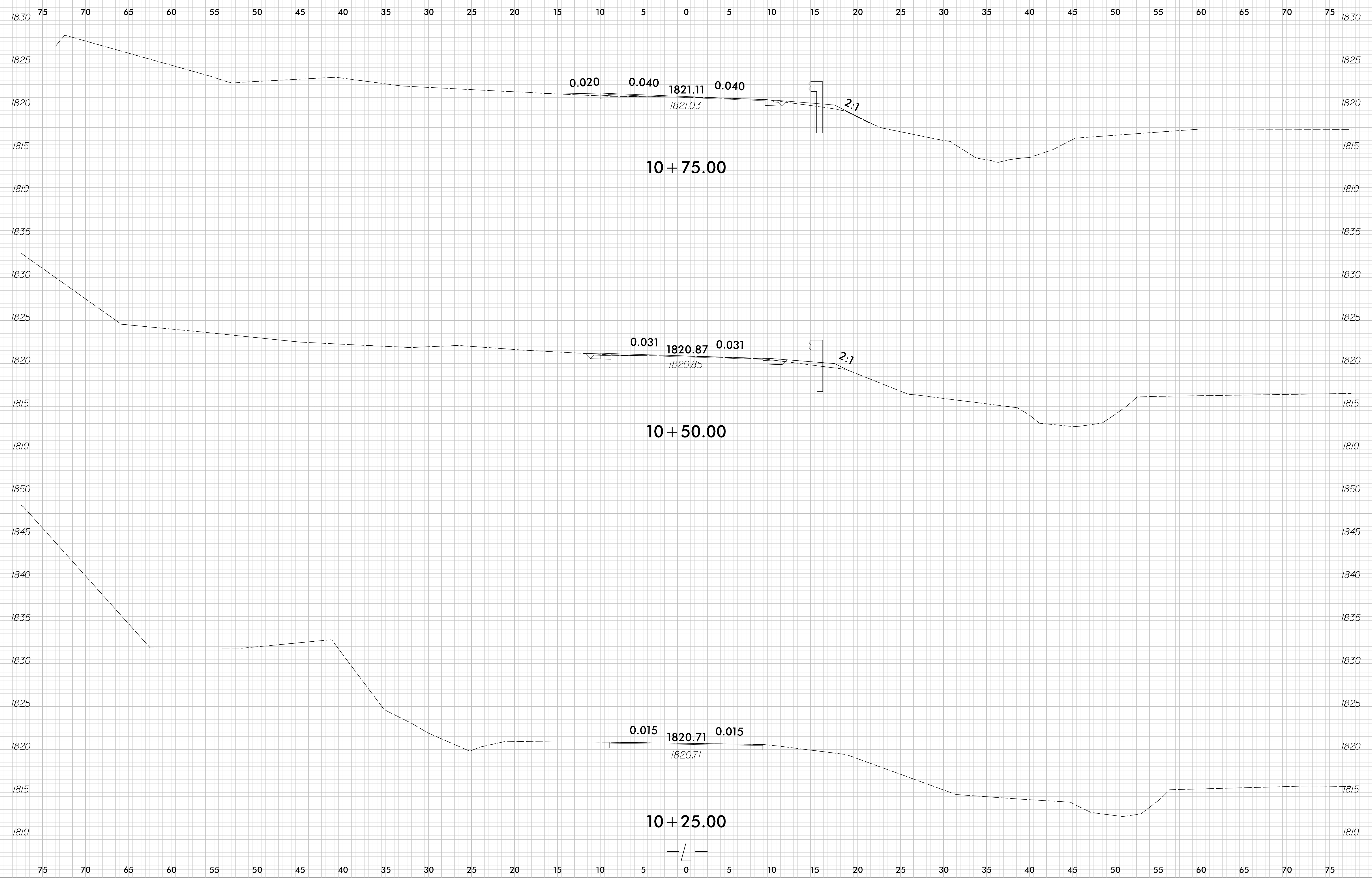

10/5/2015 11:17:18 AM C:\Users\17BP.14.R.79\3700871\Roadway\XSC\R.79\_FDY\_XPL.dgn

8/23/99

0 2.5 5	PROJ. REFERENCE NO.	SHEET NO.
	17BP.14.R.79	X-2

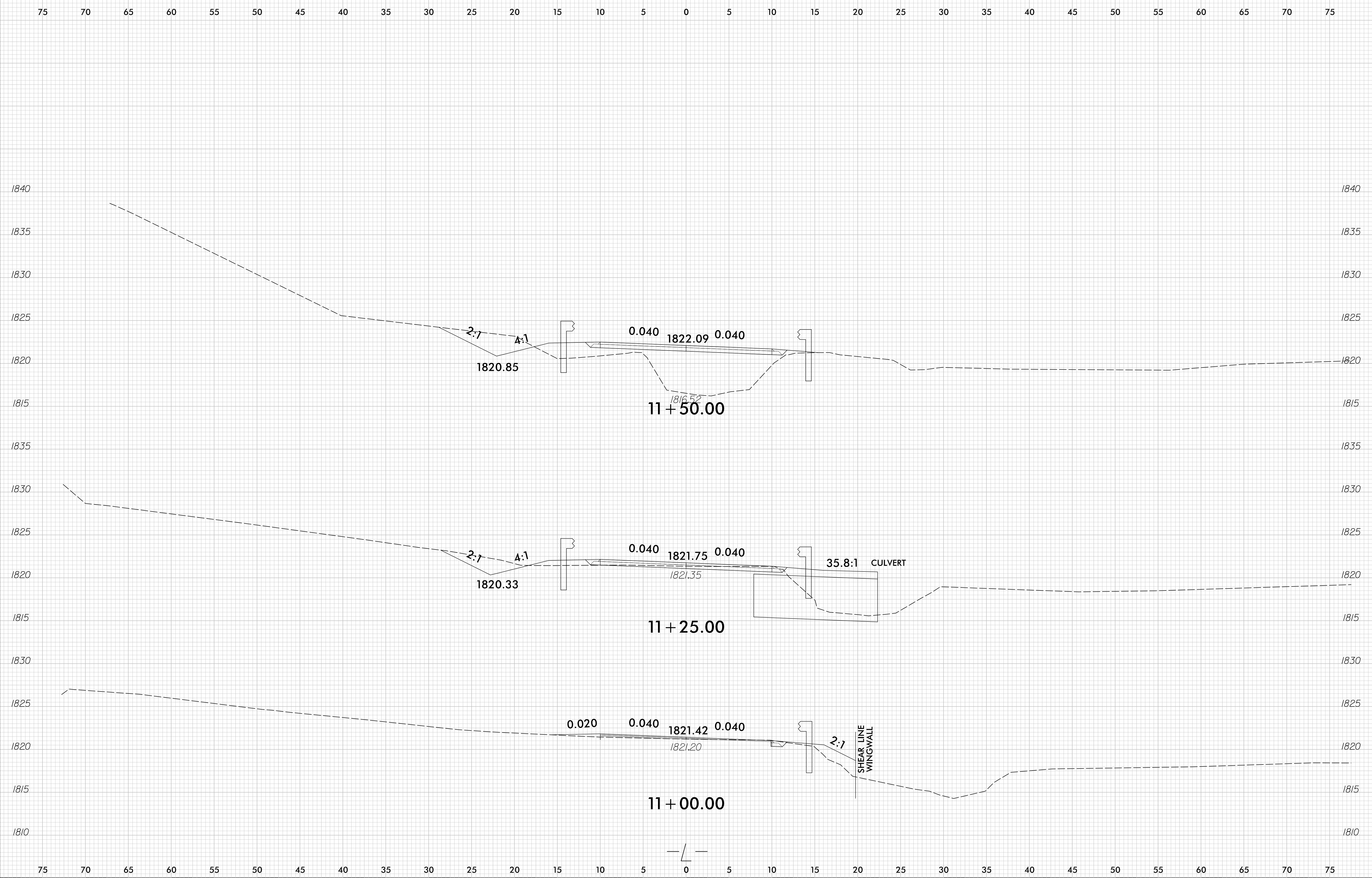

10/5/2015 11:17:18 AM C:\Users\117BP.14.R.79\370087\Roadway\XSC\R.79\_FDY\_XPL.dgn

8/23/99

0 2.5 5	PROJ. REFERENCE NO.	SHEET NO.
	17BP.14.R.79	X-3

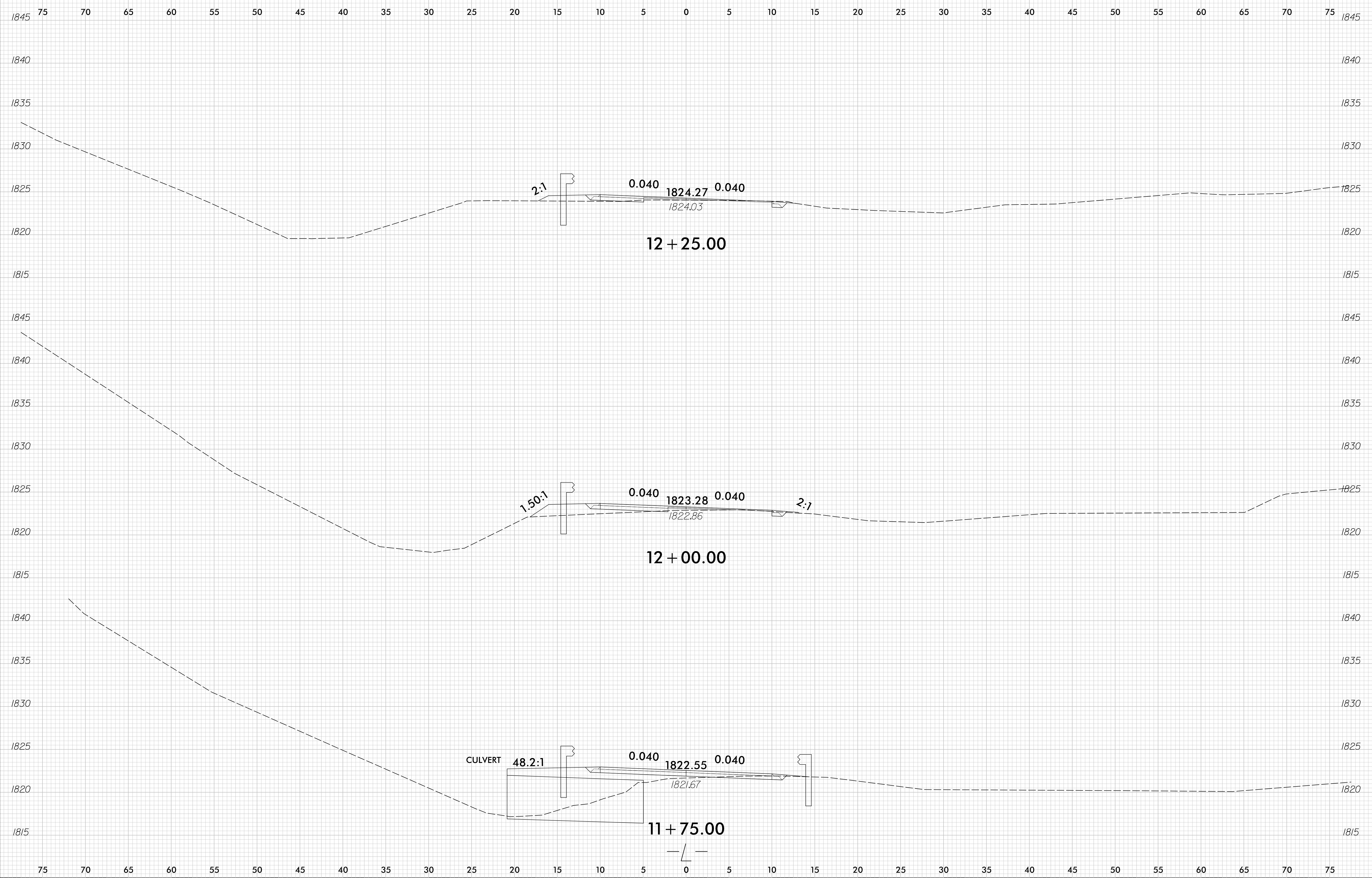

10/5/2015 11:17:18 AM C:\Users\17BP.14.R.79\3700871\Roadway\XSC\R.79\_FDY\_XPL.dgn

75 70 65 60 55 50 45 40 35 30 25 20 15 10 5 0 5 10 15 20 25 30 35 40 45 50 55 60 65 70 75

8/23/99

0 2.5 5	PROJ. REFERENCE NO.	SHEET NO.
	17BP.14.R.79	X-4

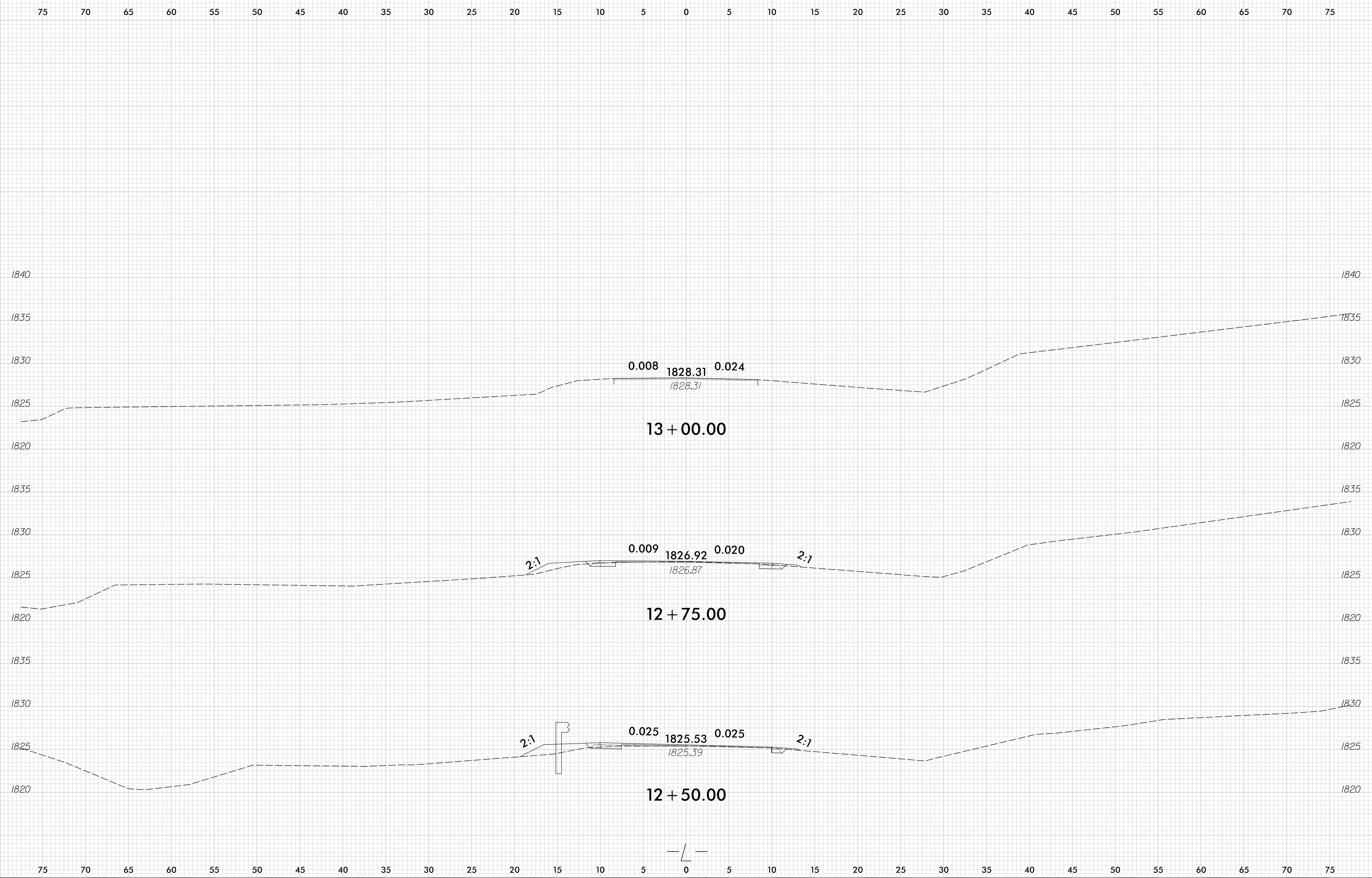

10/5/2015 11:17:14 AM C:\Users\17BP\14.R.79\370087\Roadway\XSC\R.79\_FDY\_XPL.dgn

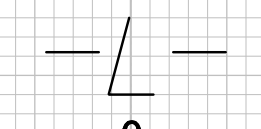

8/23/99

0 2.5 5	PROJ. REFERENCE NO.	SHEET NO.
	17BP.14.R.79	X-5

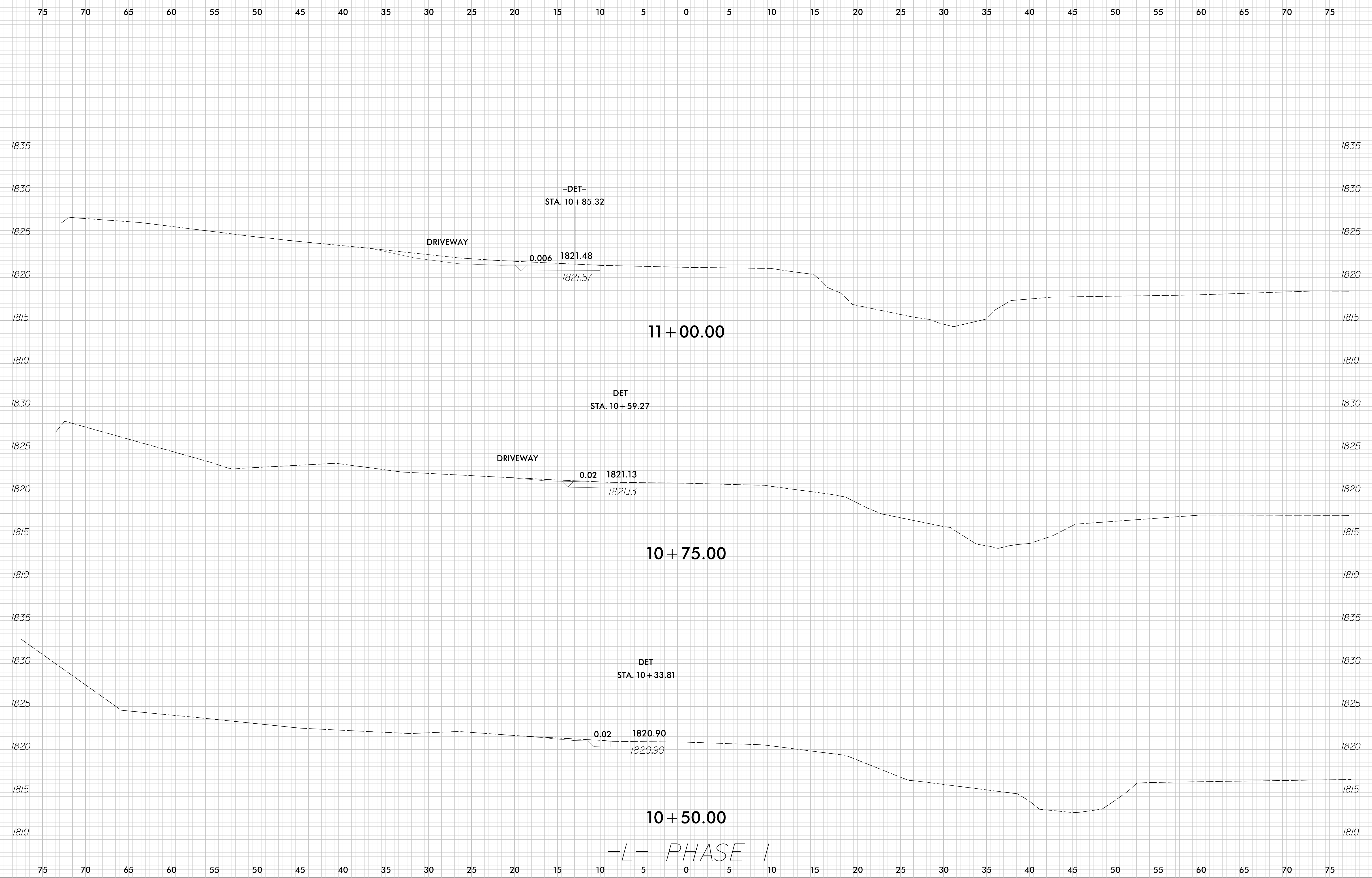

-L- PHASE I

I:\30\2015\17BP.14.R.79\370087\Roadway\XSC\R.79\_FDY\_XPL\_DET.dgn

8/23/99  
11/30/2015  
17BP.14.R.79.3700871.Roadway\XSC\R.79.FDY\_XPL\_DET.dgn

0 2.5 5	PROJ. REFERENCE NO.	SHEET NO.
	17BP.14.R.79	X-6

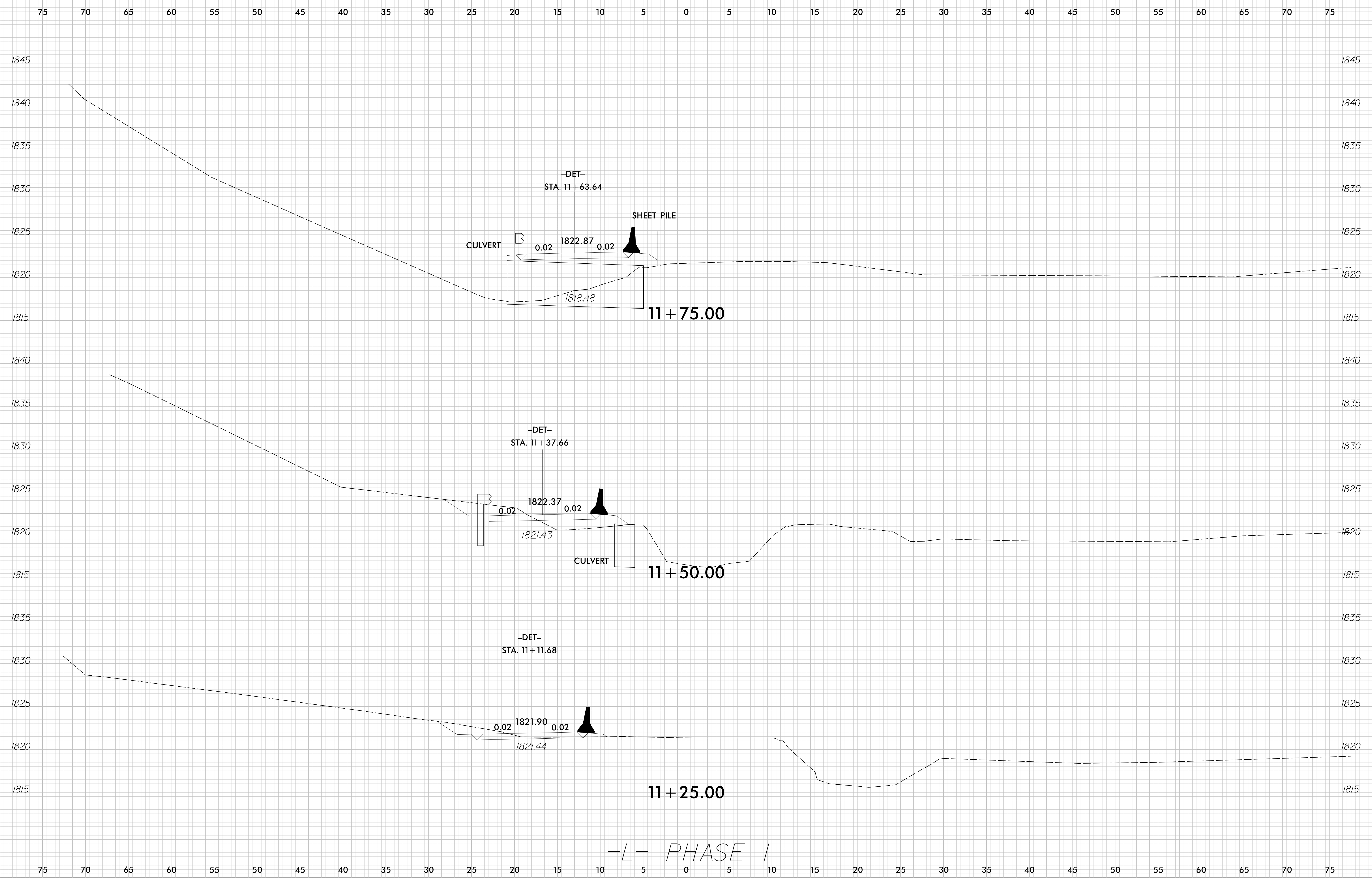



8/23/99  
I:\30\2015\17BP.14.R.79\370087\Roadway\XSC\R.79\_FDY\_XPL\_DET.dgn  
17BP.14.R.79

0 2.5 5	PROJ. REFERENCE NO.	SHEET NO.
	17BP.14.R.79	X-7

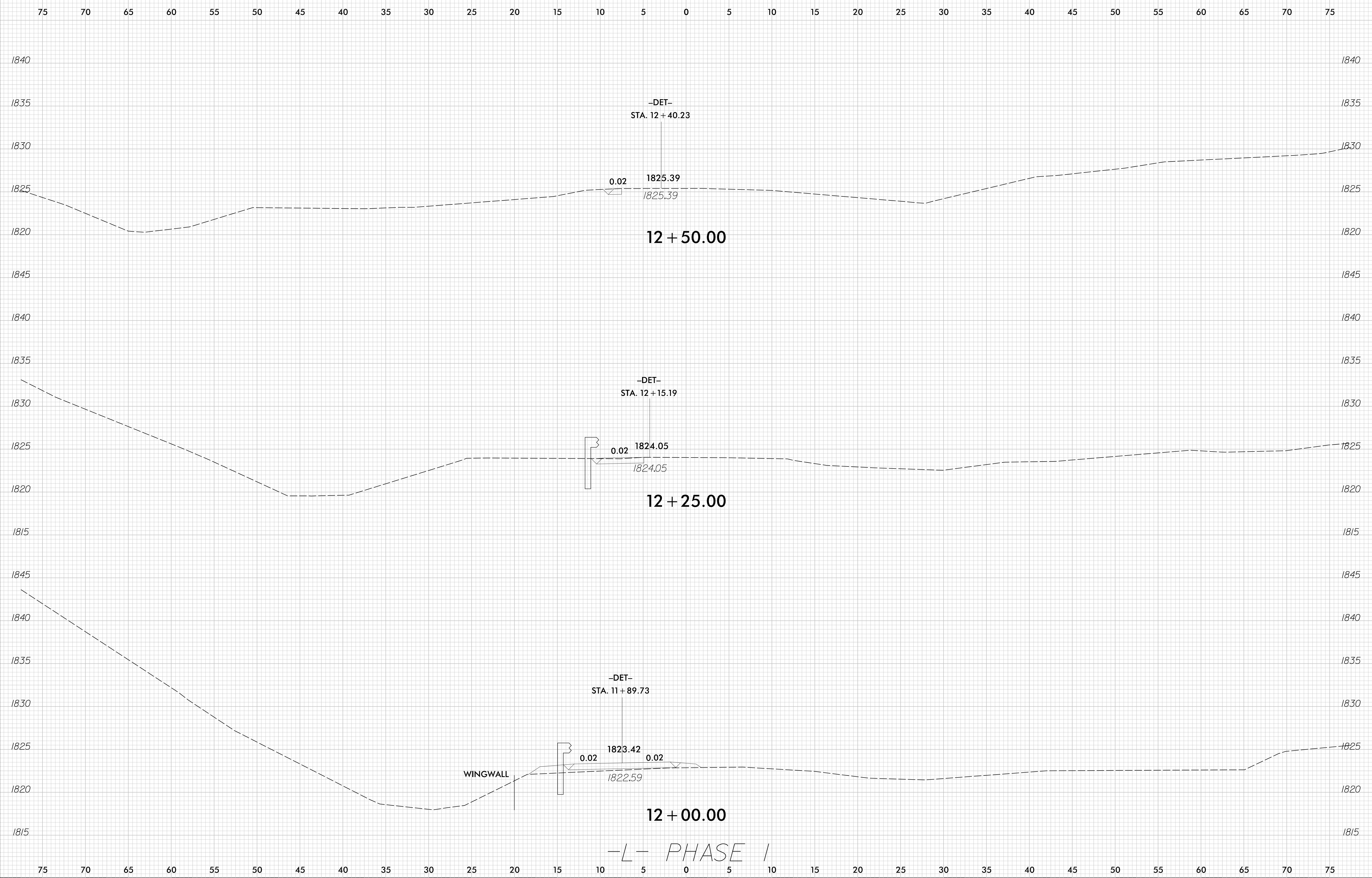

-L- PHASE I